



INSTALLATION AND USER MANUAL

Hot Water Timer



AN RWC BRAND



Contents

Specification	1
Important safety information	2
Display	3
Programme setting	7
Time setting	8
Installation	9
Wiring diagram	10
Connecting the App	11

Specification

Power source: 100-240VAC 50/60Hz

Load current output: 250VAC 3(2)A

Storage temperature: -10~60°C, 0~90%RH

Ambient temperature: 0~50°C, 0~80%RH

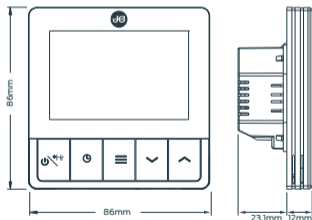

Important safety information

Read all of the information in this manual before installing this thermostat.

Always turn off the power at the main power source by unscrewing the fuse, or switching the circuit breaker to the off position before installing, removing, cleaning, or servicing this thermostat.

Only a professional contractor should install this thermostat.

All wiring must conform to local and national building and electrical codes and regulations.

If the system is not operating properly, check the wiring and replace the fuse if necessary.

Use this thermostat only as described in this manual.

Display

- a  ON/OFF/Boost
- b  Time setting
- c  Menu button
- d  Lower temperature setting
- e  Raise temperature setting
- f  Reset

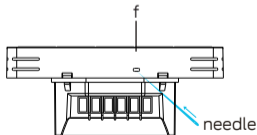
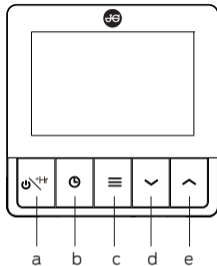

- 1 If the icon  is not shown then Wi-Fi is not connected
If the signal is lost after connection the icon will flash
- 2 Programming periods display
(4 separate periods per day)
- 3 ON/OFF
- 4 Key lock
- 5 Holiday Mode
- 6 Time display
- 7 AM/PM
- 8 Boost function
- 9 Day of week
- 10 Mode: ON / ALL DAY / AUTO /
OFF / ADV



ON: Continuously on

ALL DAY: On for 1 period a day, from Program 1 ON to Program 4 OFF

AUTO: Automatic program control

OFF: Continuously off

ADV: When the device is in AUTO/ALL DAY mode, press and hold '⌚' to switch to ADV mode, and the device will move the unit into the next program, When the ADV function ends the device will return to normal program. Press '☰' cancel ADV.

When in Auto mode selecting ADV, the thermostat will simply toggle the current auto setting (ON or OFF). If the program is set as:

08:00 ON ➔ 09:00 OFF ➔ 10:00 ON ➔ 11:00 OFF

Selecting ADV between 8:00 and 8:59 will change the output to OFF, from 9:00 onwards back to AUTO(which is also OFF). Selecting ADV between 9:00 and 09:59 will change the output to ON, from 10:00 onwards back to AUTO(which is also ON). If the ADV puts the relay On then the boost would apply immediately at the next OFF change, if the ADV puts the relay OFF then the boost would apply immediately and turn the relay ON.

08:00 OFF ➔ 10:00 ON ➔ 12:00 OFF ➔ 14:00 ON

If ADV occurs at 08:30 and the relay is On from 08:30 to 12:00. During this period, if at 08:45 +1Hr (Boost) is pressed, the relay will be ON from 08:30 to 12:00. Boost is applied immediately ie from 08:45 to 09:45 at the next change, ie. 12:00. If ADV occurred at 10:30 the relay will be ON from 10:00, OFF from 10:30(ADV) to 14:00 if no +1Hr Override. During ADV, if at 10:45 +Hr (Boost) is pressed, the delay will go ON again at 10:45 (boost starts), OFF at 11:45 (Boost ends) until ends at 14:00, then On again at 14:00.

ON/OFF button

Press and hold '⏻' 3 seconds to power off, displaying 'OFF'. In power off, press '⏻' to power on the device.

Mode option ON/ALL DAY/AUTO/OFF/Holiday

Press '☰' to switch mode, it will display the mode you select.

Holiday mode

In power on, press '☰' switch from ON/ALL DAY/AUTO/OFF/Holiday mode.

After selected holiday mode displayed '🏠' and keep off output until you press '☰' button to end holiday mode.

Boost function

Press '⏻' to activate boost function in power on status. When display shows '+0', press '▼' '▲' to select boost hour. Based on setting time of boost to heat and count back displayed until the Boost function ends. Press '⏻' to cancel the boost function when it is in active status.

Key lock

Press and hold '▼' '▲' at the same time to activate or cancel the key lock. When activated the timer will display '🔒'

Backlight mode

With the thermostat turned off, press and hold '☰' to enter the backlight setting interface. Press '▼' '▲' to adjust parameters. 1: Backlight always bright;
2: When button is pressed, backlight is bright for 15 seconds; 3: backlight is off

Programme setting

When the thermostat is on, press and hold '≡' to enter the programming mode, press '▼' or '▲' to select the programming week (5+2, 5+1+1 or 7 individual day optional).

Press '≡' to 1st ON time setting mode. Press '▼' or '▲' to select time, press '≡' to 1st OFF time setting mode. Press '▼' or '▲' to select time. When you have finished setting the four time periods press '≡' to save and exit.

If no buttons are pushed for 10 seconds, the thermostat will exit the programme setting automatically.

Default programming

1st		2nd		3rd		4th	
ON	OFF	ON	OFF	ON	OFF	ON	OFF
0:00am	0:00am	6:00pm	7:00pm	12:00pm	12:00pm	4:00pm	5:00pm

Time setting

Press and hold '⏸' for 4 seconds, press '⌚' to select year, month, day, time scale, time, press '↓' '↑' to adjust setting, press '⏸' to confirm.

If there are no actions for 10 seconds, the thermostat will return to temperature display mode.

Press '⌚' to check time, year, month, day.

Setting the date and time on initial start up

Plug in the power supply. Press '↓' or '↑' to set year, press '⌚' to set month, day, time scale, time, press '↓' '↑' to adjust the setting.



Year



Month



Day



12h/24h optional



Time

Installation

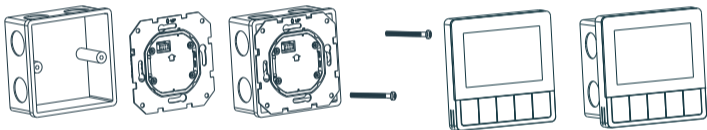

1 Install the base

2 Mounting screws

3 Install the panel

4 Finish

Wiring diagram

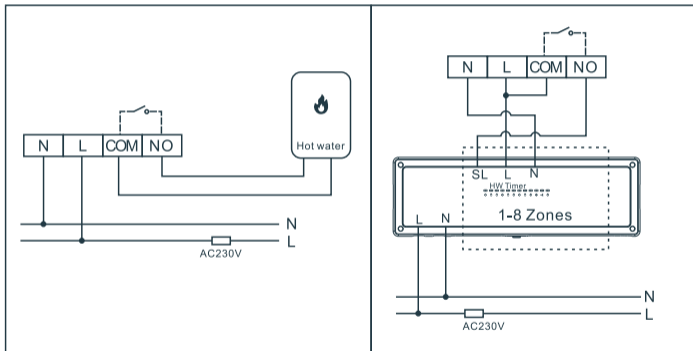

Suggest cable is not over 1.5mm

Connecting the App

Download and register

Click App store (click Android application market)
Search for 'JG Underfloor' and download

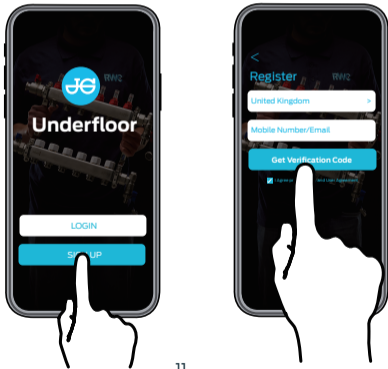

Login

When you finish the registration, log into your email and click on the link to activate your account. Your APP is now ready to use.

Registered mailbox /phone number

Insert your password

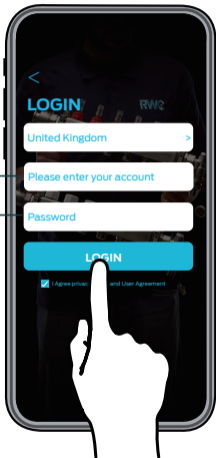

First, please turn on the location of your phone

Before adding the thermostat to your app, make sure to turn off the thermostat and then press and hold '⏻' for 3 seconds, the thermostat display will show '— —'. Then go to the JG Underfloor app.

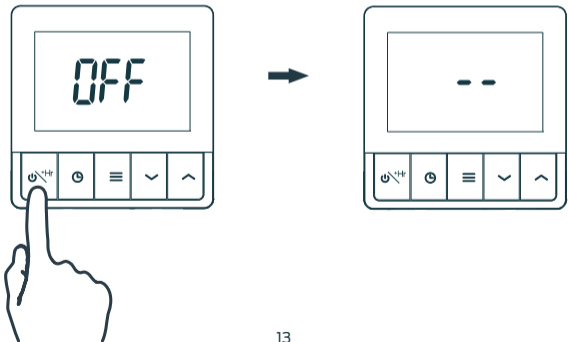



- 1 Click '+' on the top right



- 2 Click 'Timer'

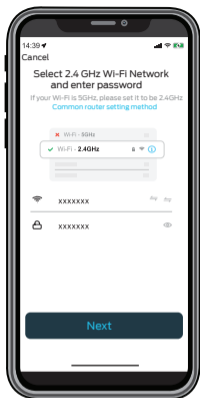

- 3 Select your home Wi-Fi, and enter password, then click 'Next'

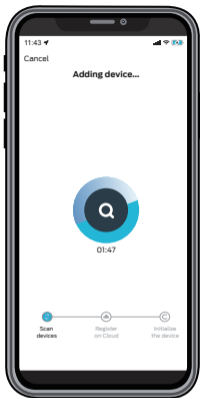

4 Adding device...



5 Added successfully
Click 'Done'.



Click to set time

Click to select Auto/On/Off/
All day mode

Slide to open the
'Child Lock' function

Click to select Auto/On/Off
/all day mode

When domestic hot water
turns on, icon will turn to blue

Boost function and select from
0-9 hours, and display with blue,
cancel turn to grey.

Only activate in Auto and
ON mode.

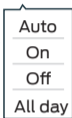

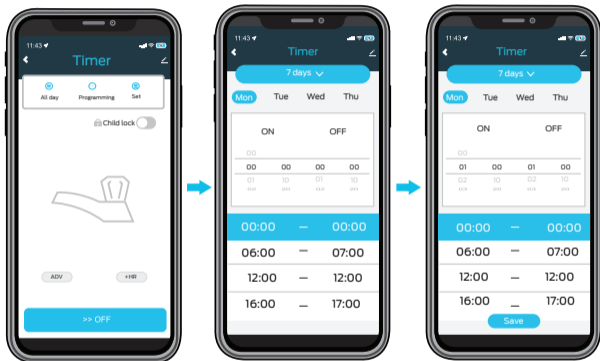

Click 'Programming' to enter the programming mode, and click '7 days' to select the date to programme, then click 'Save'.



Click '' to view the device information 

Click 'Alexa' to link your Alexa account

Click here to remove device

Slide to power on/power off

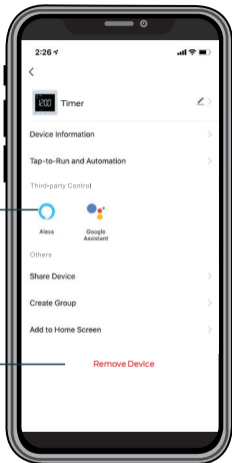

Voice command:

After waking up the speaker you can say:

Amazon Alexa

- * Alexa, turn on <device name>.
- * Alexa, turn off <device name>.
- * Alexa, set <device name> to <mode>.
- * Alexa, what is the mode on <device name>?

Google Assistant

- * Ok, Google, turn on <device name>.
- * Ok, Google, turn off <device name>.
- * Ok, Google, set <device name> to <mode>.
- * Ok, Google, is <device name> on?



**Reliance Worldwide
Corporation (UK) Limited**

Horton Road
West Drayton
UB7 8JL
United Kingdom
Tel: +44 (0) 1895 449233

Reliance Worldwide Corporation
(UK) Limited reserves the right
to make changes to the product
which may affect the accuracy
of information contained in
this leaflet.

www.johnguest.com



JG/VER3122

AN RWC BRAND
RWC